

Ø 10 - 12 mm

TOPTEK®
HARDWARE ELECTRONIC MANUFACTURER

Z-TOP-Q12BJ-DL-N



Diameter: Ø 12mm
Color: R, G, Y, O, B, W
Switch Rating: 2A/36VAC
Contact Configuration: 1NO
Operation Type: Maintained
Lamp type: Dot illuminated (LED)
The Crust Material:

- Stainless steel
- Copper plating

IP Degree: IP67, IK10

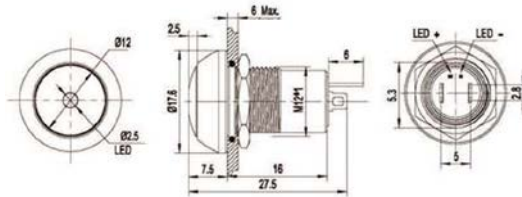

14
*
41

Z-TOP-12BJ-L-N



Diameter: Ø 12mm
Color: R, G, Y, O, B, W
Switch Rating: 2A/36VDC
Contact Configuration: 1NO
Operation Type: Momentary
The Crust Material:

- Stainless steel
- Copper plating

IP Degree: IP67, IK08

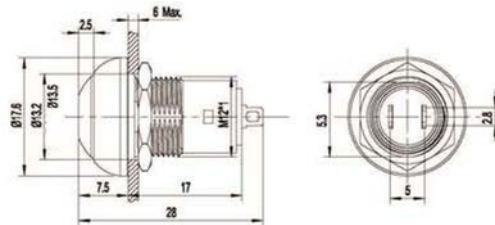

Z-TOP-12F-10EM



Diameter: Ø 12mm
Color: R, G, Y, O, B, W
Switch Rating: 2A/36VDC
Contact Configuration: 1NO
Operation Type: Momentary
Lamp type: Ring illuminated (LED)
The Crust Material: Stainless steel
Degree: IP67, IK08

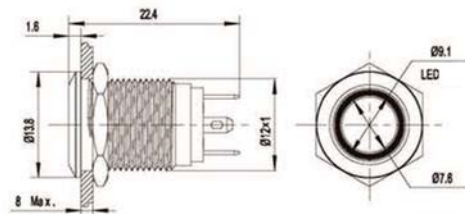

Z-TOP-12H-10EM



Diameter: Ø 12mm
Color: R, G, Y, O, B, W
Switch Rating: 2A/36VDC
Contact Configuration: 1NO
Operation Type: Momentary
Lamp type: Ring illuminated (LED)
The Crust Material: Stainless steel
Degree: IP67, IK08

